

STAND FOR RF-25/RF-30

Contents of the Shipping Container:

- 2 Side Panels
- 1 Front Panel
- 1 Rear Panel (two holes)
- 1 Top Tray
- 1 Door
- 1 Shelf

Hardware Kit contents:

- 18 Hex Cap Bolt with integral washer
- 4 Hex Nuts
- 4 Hex Cap Bolts (long)
- 4 Plastic Washers
- 8 Flat Washers
- 1 Door Latch
- 1 Door Catch
- 2 Pan Head Screws
- 2 Pan Head Screws w/ integral washer
- 2 Spacers

Tools Needed for Assembly:

- 1 - 12mm Box Wrench
- 1 - #1 Cross Point Screwdriver

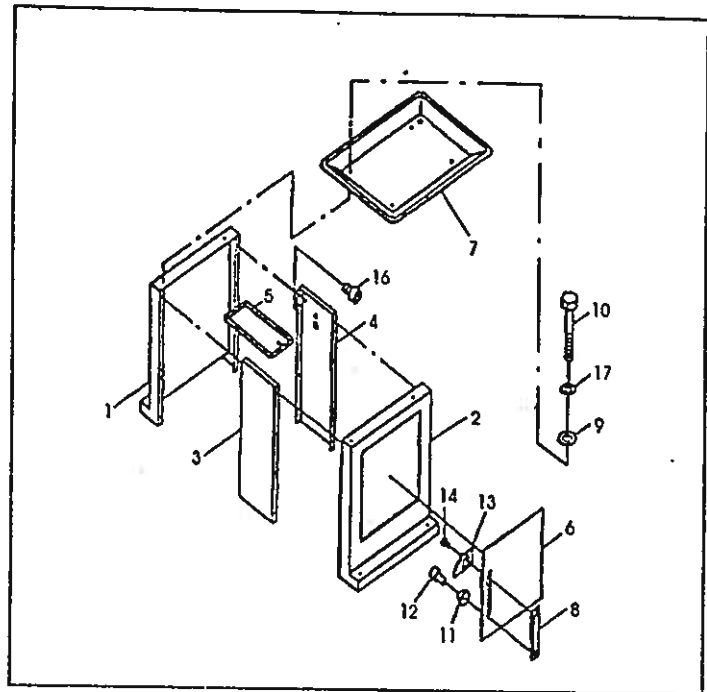

Assembly

1. Lay front panel (3) flat on a protective surface.
2. Place side panels (1 & 2) next to front panel so the holes line up in both side and front panels.
3. Attach the front panel to the side panel with eight hex cap bolts (16). (Bolts have an integral washer. Do not tighten bolts at this time)
4. Attach rear panel (4) to side panels with eight hex cap bolts (16). Do not tighten bolts at this time.
5. Turn stand right side up before tightening all bolts securely.
6. Attach the door latch assembly (8, 11, 12, 13, and 14) to the door (6).
7. Install the door (6) to the side panel (2).
8. Attach the internal shelf (5) with two hex cap bolts.
9. Place the stand top (7) onto the stand assembly and line up holes. The drain hole in the stand top is placed to the stand rear.
10. Place four nylon washers (9) over the openings in the stand top (7).
11. With a mechanical aide, carefully place the mill on the stand top making sure the holes in the mill/drill base line up with the holes in the stand top.
12. Attach the mill/drill to the stand top with four hex cap bolts (10), eight washers (17), and four hex nuts (not shown).